

8/17/99

REVISIONS

12/4/2025  
R:\Projects\23-070.0\W-5805G\Updated Files\Roadway\W-5805G\_Rdy\_psh4\_TCP\_IIA.dgn  
User:kassymartinez

**LEGEND**

NEW TEMPORARY MARKINGS

EXISTING MARKINGS (GRAY)

NOTE: MAINTAIN DRIVEWAY ACCESS WHILE UNDER CONSTRUCTION.

NOTE: ALL LANE WIDTHS ARE 12' UNLESS OTHERWISE SHOWN.



ICE of Carolinas, PLLC  
4505 Falls of Neuse Road, Suite 110  
Raleigh, North Carolina 27609  
Phone: 803-822-0333  
License #: P-0999

APPROVED:   
DATE: 12/4/2025

SEAL

DOCUMENT NOT CONSIDERED FINAL  
UNLESS ALL SIGNATURES COMPLETED



TEMPORARY TRAFFIC  
CONTROL  
PHASE IIA DETAIL

PROJ. REFERENCE NO.	SHEET NO.
W-5805G	TMP-07

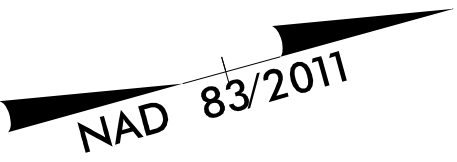

USING ROADWAY STANDARD DRAWING  
1101.01 SHEET 2 OF 3, ERECT WORK  
ZONE ADVANCED WARNING SIGNS ON  
US 1.

USING ROADWAY STANDARD DRAWING  
1101.02 SHEET 3 OF 19,CLOSE THE  
LEFT LANE FOR NB US 1.

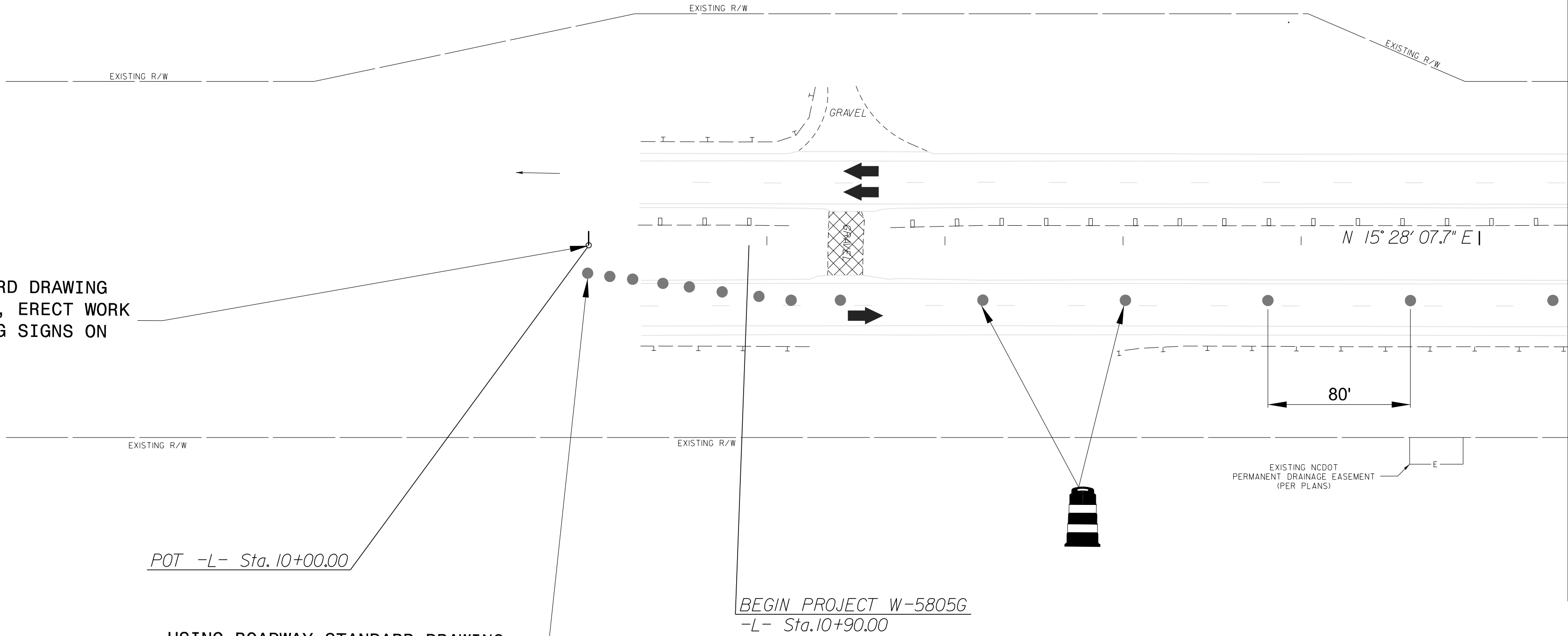

MATCHLINE -L- Sta.15+50.00  
(SEE SHEET TMP 08)